

Tezgah üstü armatür kullanılacak ise 1 nolu adımlar uygulanır.

If the counter requires a hole for the faucet, apply step 1.

Si le plateau doit être percé pour un robinet suivre les étapes "1" Notez qu'il faut percer la tablette ainsi que le caisson support.

Wenn eine nicht wandmontierte Armatur installiert werden soll, muss das Hahnloch vorgebohrt werden. Beachten Sie, dass sowohl Konsolenplatte wie auch Unterbau entsprechend gebohrt werden müssen.

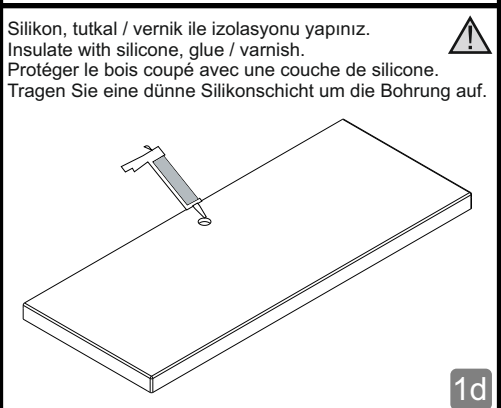
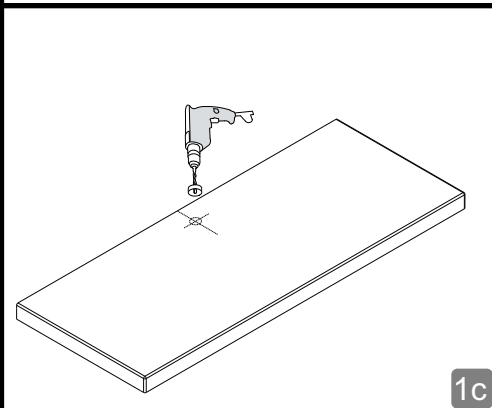
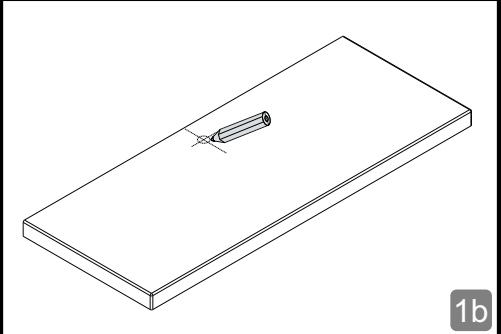
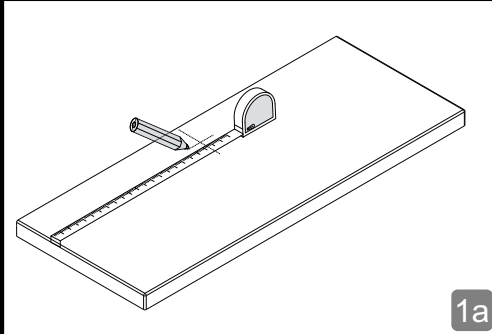

Silikon, tutkal / vernik ile izolasyonu yapınız.

Insulate with silicone, glue / varnish.

Protéger le bois coupé avec une couche de silicone.

Tragen Sie eine dünne Silikonschicht um die Bohrung auf.

Montaj Kılavuzu • Installation • Montage

Kullanılacak lavaboya uygun kesim şablonu ile kesim yeri belirlenmelidir.

The hole should be determined with a cross section template suitable for the washbasin to be used.

Le trou doit être déterminé à l'aide d'un gabarit de coupe adapté au lavabo à utiliser.

Das Loch sollte mit einer für das zu verwendende Waschbecken geeigneten Querschnittsschablone bestimmt werden.

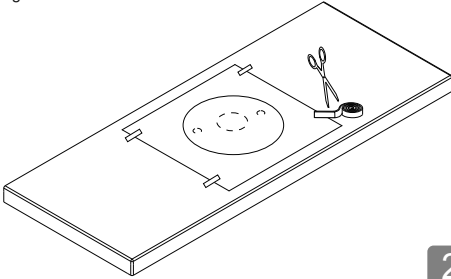

2

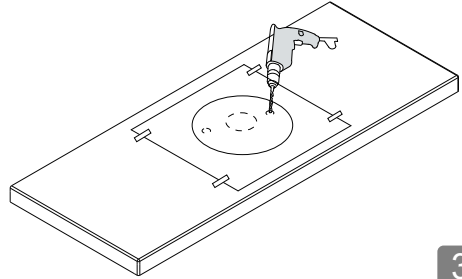

3

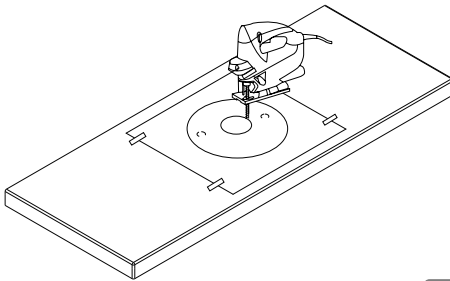

4

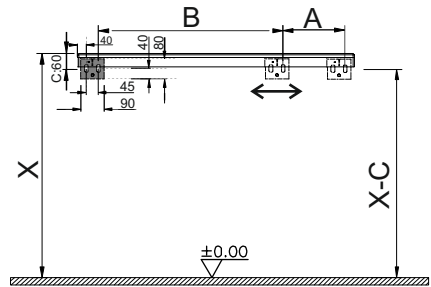

5

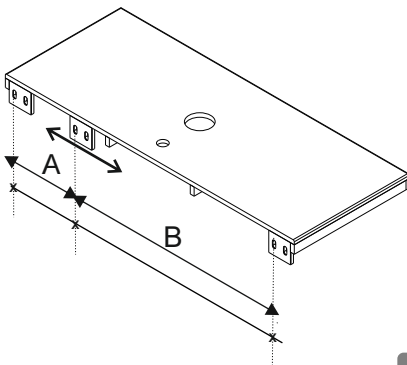

6

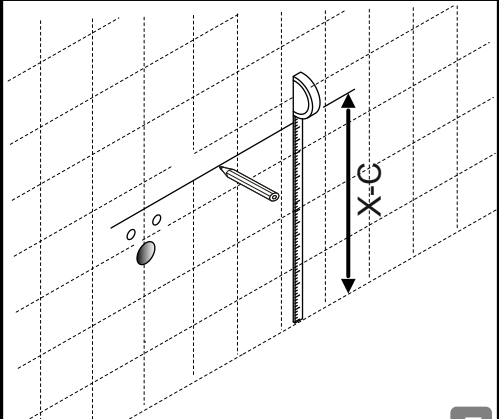

7

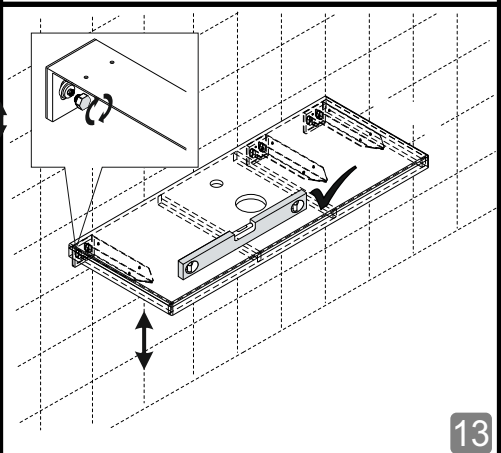
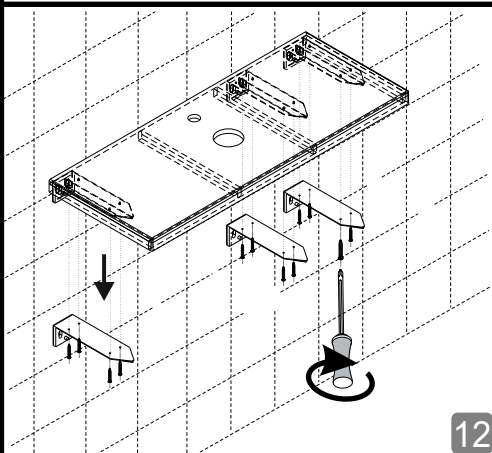
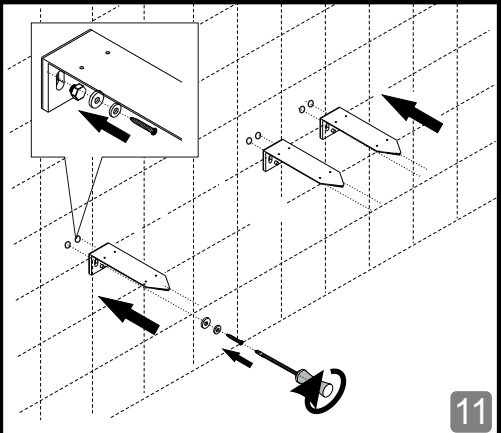
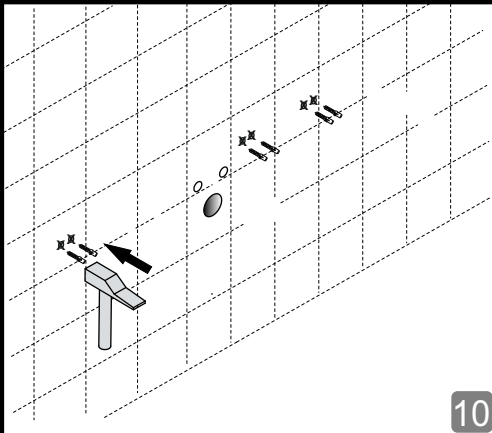
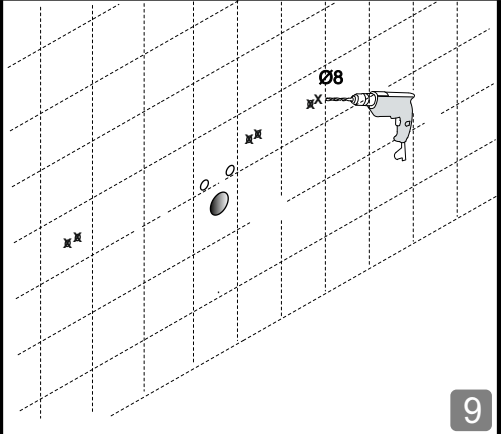
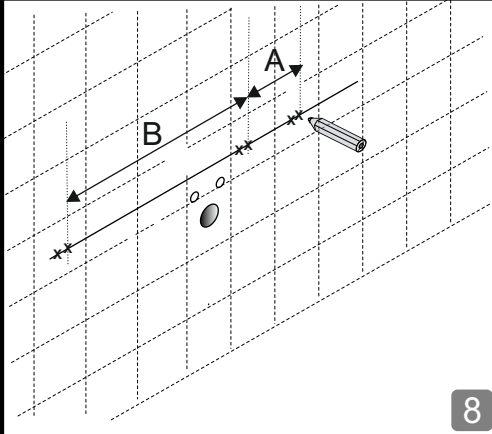



Su izolasyonu için lavabo montajı öncesi delinen bölgeyi uygun bir su yalıtım malzemesi ile kapatınız.
For the water insulation cover the drilled area with a suitable waterproof material before the installation of washbasin.
Pour l'isolation de l'eau, recouvrez la zone percée d'un matériau imperméable approprié avant l'installation du lavabo.
Für die Wasserisolierung den gebohrten Bereich vor dem Einbau des Waschbeckens mit einem geeigneten wasserdichten Material abdecken.

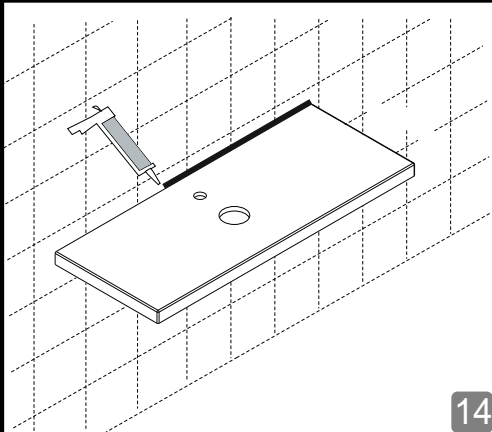

14

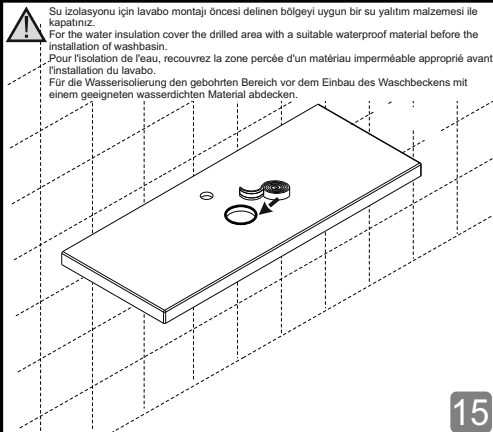

15

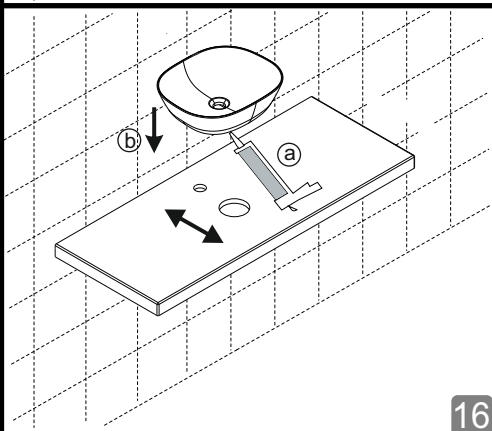

16

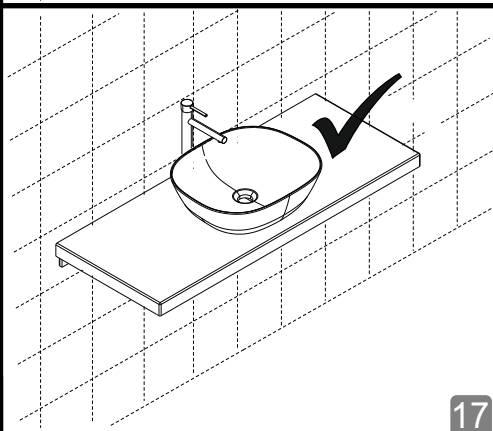

17